

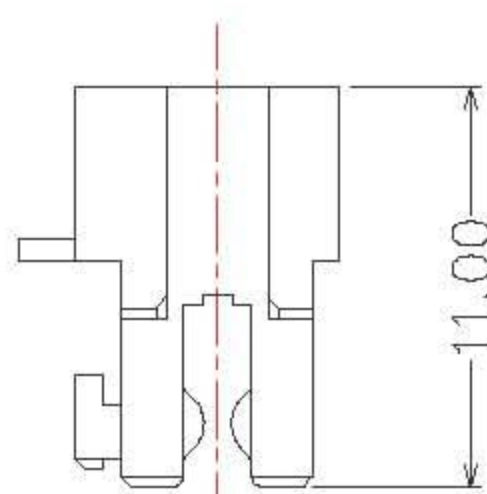

# M7280

## SPECIFICATION

Current rating: 3AAC, DC  
 Voltage rating: 32VAC, DC  
 Operating Temperature: -40 °C--+120 °C  
 Contact Resistance: 10mΩ max.  
 Insulation resistance: 1000MΩ min.  
 Withstanding voltage: 1400V AC/minute  
 Material: Housing:Nylon66 UL94V-0  
 Terminal: Phosphor bronze, Tin-plated  
 Wire range: AWG 24 to 22  
 GWT:750 °C IEC-60335-1

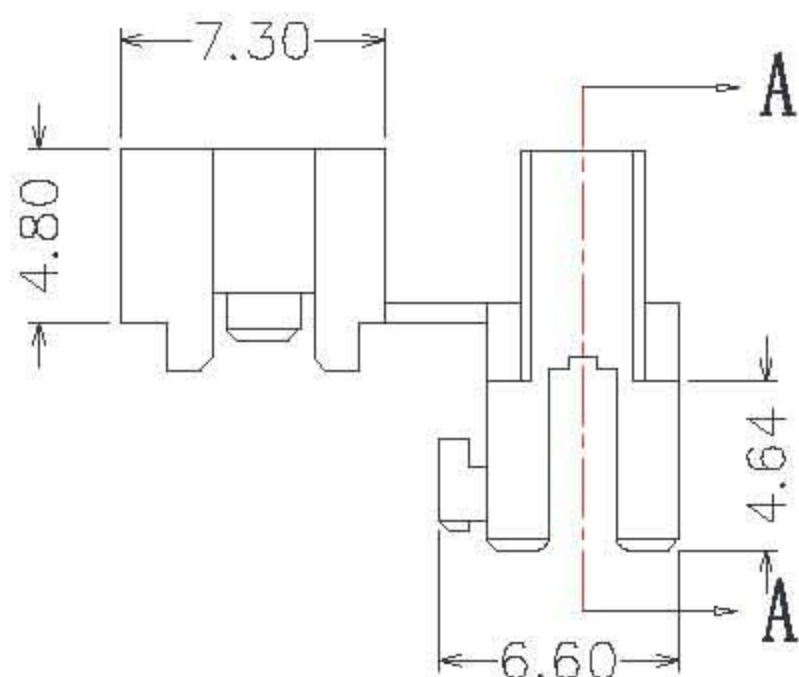
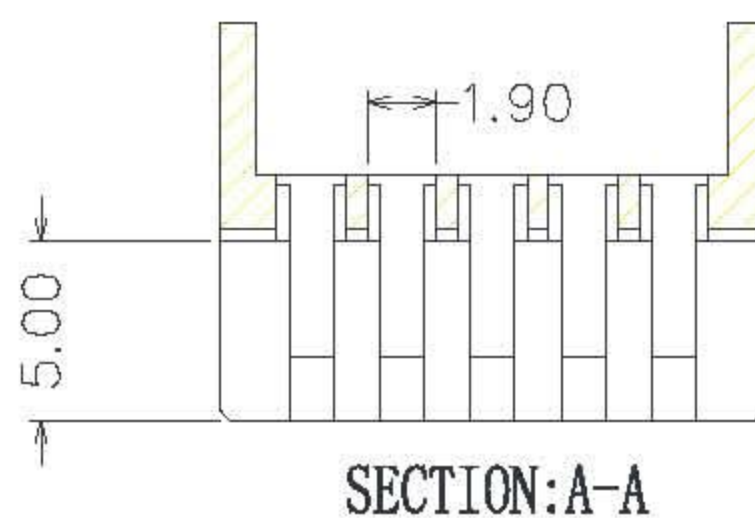
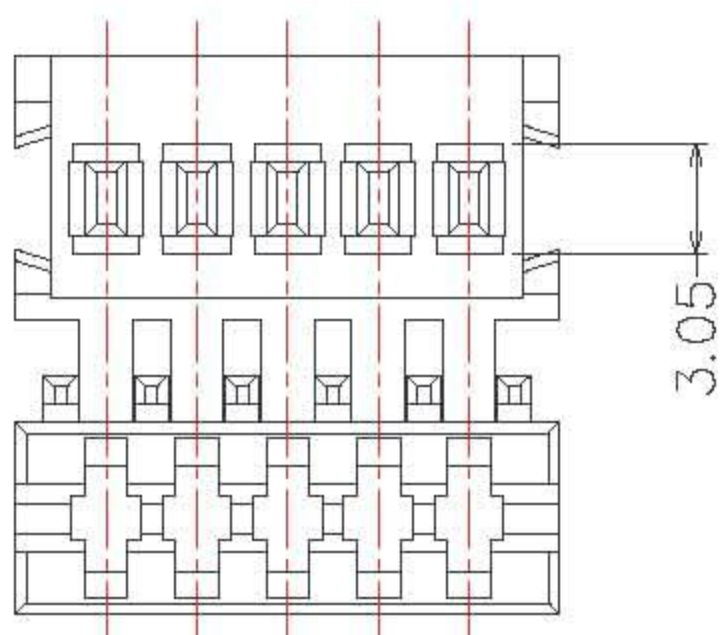
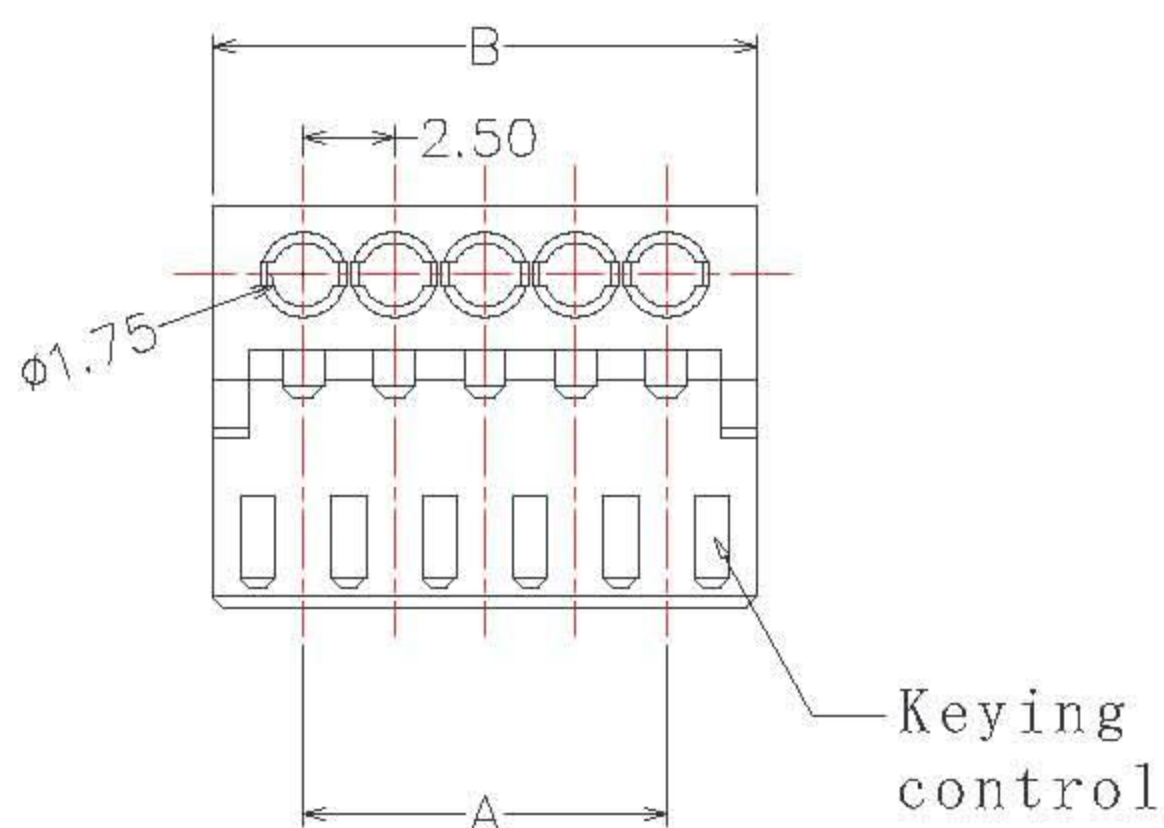
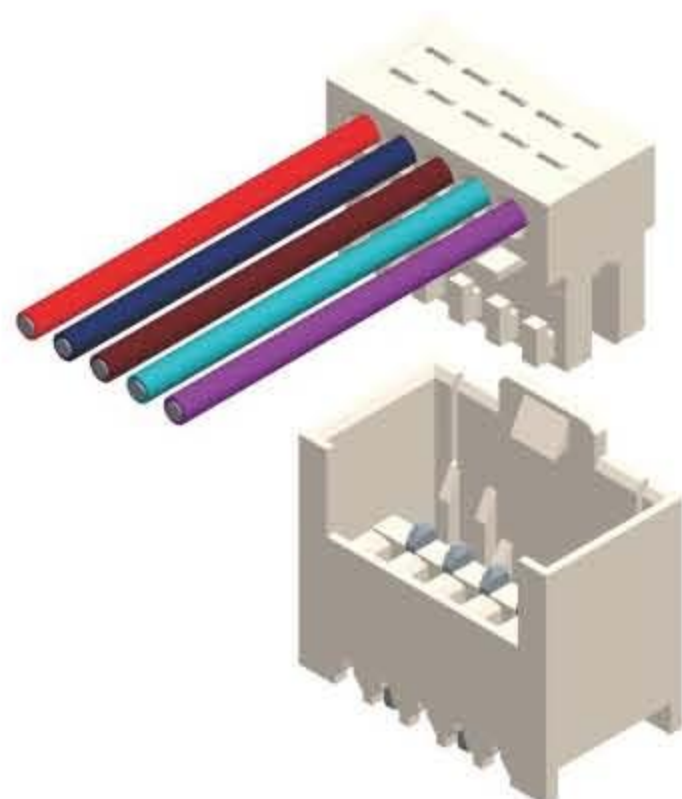

| Dimension |      |      |
|-----------|------|------|
| Pos. No.  | A    | B    |
| 2         | 2.5  | 7.5  |
| 3         | 5.0  | 10.0 |
| 4         | 7.5  | 12.5 |
| 5         | 10.0 | 15.0 |
| 6         | 12.5 | 17.5 |
| 7         | 15.0 | 20.0 |
| 8         | 17.5 | 22.5 |
| 9         | 20.0 | 25.0 |
| 10        | 22.5 | 27.5 |
| 11        | 25.0 | 30.0 |
| 12        | 27.5 | 32.5 |
| 13        | 30.0 | 35.0 |
| 14        | 32.5 | 37.5 |
| 15        | 35.0 | 40.0 |
| 16        | 37.5 | 42.5 |
| 17        | 40.0 | 45.0 |
| 18        | 42.5 | 47.5 |
| 19        | 45.0 | 50.0 |
| 20        | 47.5 | 52.5 |

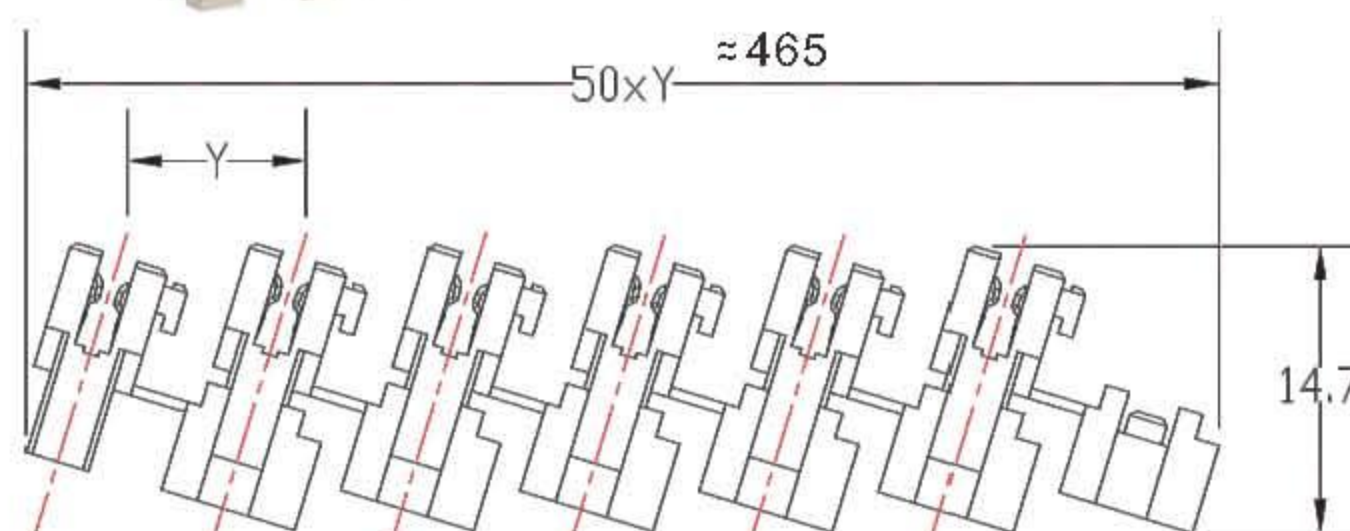
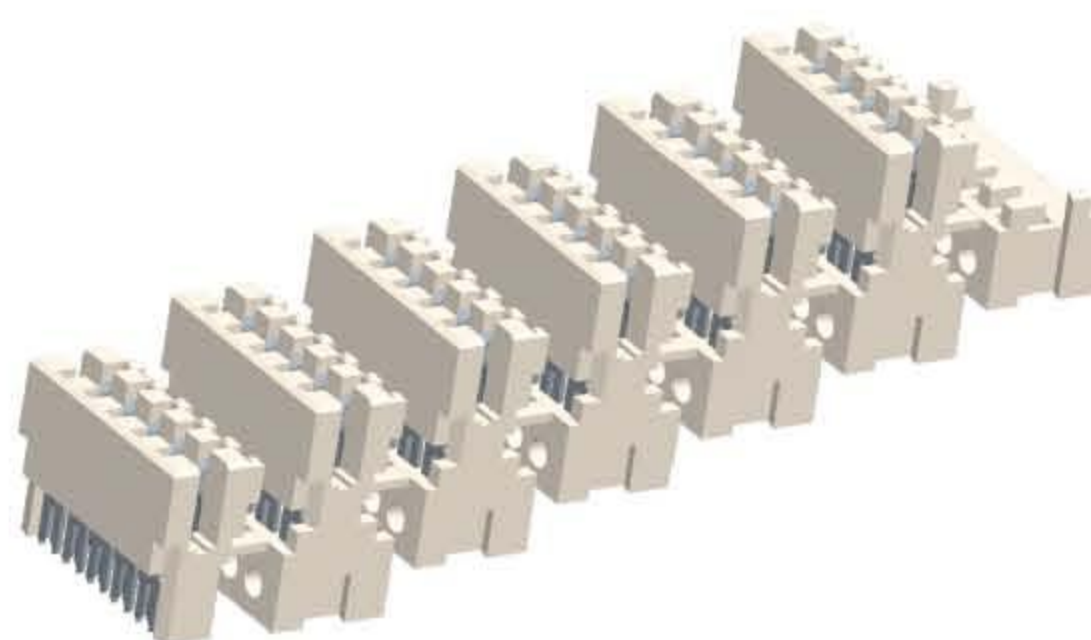

## M7280 Part Number Definition

M7280-X-XXX-X(X)

